

# Particulate Matter Monitor



**MEZUS** 610

## Features

- Ranges - 0~1,000 / 2,000 / 5,000 / 10,000 $\mu\text{g}/\text{m}^3$  user selectable.
- 7inch TFT LCD touch screen interface.
- Ethernet, RS-232, RS-485 & USB ports.
- USB interface utilizes for System Program Update.
- Temperature & pressure compensation
- Stored data can be retrieved RS-232, USB Interface and TCP/IP network
- In built Data Logger Utilizes NAND-Flash to Store up to 5min/1year averaged data

## Specifications

Measuring Items	SPM in the ambient air
Measuring Method	Beta ray attenuation method
Range	0~1,000 / 2,000 / 5,000 / 10,000 $\mu\text{g}/\text{m}^3$ (selectable)
Accuracy	< $\pm 2\mu\text{g}/\text{m}^3$
Measurement Resolution	< $1\mu\text{g}/\text{m}^3$
Detection Limit	< $5\mu\text{g}/\text{m}^3$ hour / < $1\mu\text{g}/\text{m}^3$ day
Measurement Cycle Time	1 hour or 5min (Real mode)
Ambient temp	0~45°C
Analog Output	0~5V / 0~1V or 4~20mA(option)
Sample flow rate	Stabilized flow control by 16.7L/min, actual or standard mode
Filter Tape	Glass fiber filter tape,30mm, L=20m (100~120 days of selectable)
Display	7 inch Graphic LCD
Comport	Ethernet, USB 1.1, RS-232C , RS-485
Internal data memory	Measuring data (5min/ 1year), Operation history, Messages, Alert
Power Requirement	220VAC/60Hz or 230VAC/50Hz

# Particulate Matter Monitor



**MEZUS** 610

## Dimensions

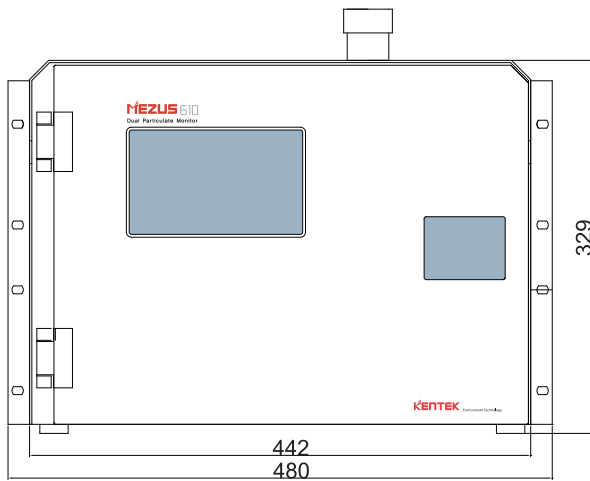

<Front>

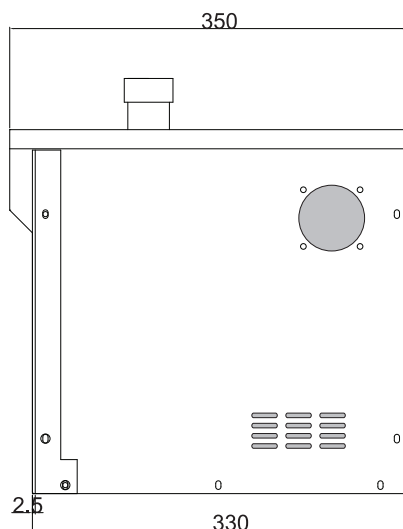

<Side>

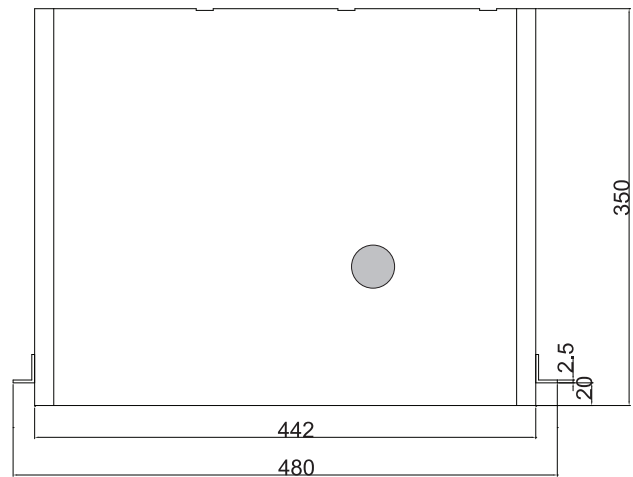

<Top>